

Proposed Paving

NORWAY PLAINS ASSOCIATES, INC.

SEEDING NOTES

1. DUE TO EXCESSIVELY DRAINING SUBSURFACE, A MINIMUM OF 6 INCHES OF TOPSOIL SHALL BE SPREAD OVER AREAS TO BE SEEDING.
2. LIME SHALL BE APPLIED PRIOR TO OR AT THE TIME OF SEEDING AT A RATE DETERMINED BY LABORATORY TESTING OF SOIL.
3. FERTILIZER SHALL BE APPLIED PRIOR TO OR AT THE TIME OF SEEDING AT A RATE DETERMINED BY LABORATORY TESTING OF SOIL.
4. AREA TO BE HYDROSEEDING WITH MIX OF SEED AND BULGARIAN BONDED FIBER MATRIX OR EQUAL SEEDS TO BE APPLIED AT A RATE OF 300 LBS/ACRE AND IN A MANNER CONSISTENT WITH BULGARIAN BONDED FIBER MATRIX MANUFACTURER'S SPECIFICATION (SEED MIX SHALL BE BASED BY WEIGHT); 1000 POUNDS (450L) BONDING AGENT (100) AND PERMANENT HYDROSEED (400).
5. PERMANENT SEEDING SHALL OCCUR FROM EARLY SPRING TO EARLY OCTOBER.
6. IF DISTURBANCE REMAINS UNSTABILIZED AFTER OCTOBER 15, TEMPORARY SEEDING SHALL BE CONDUCTED TO STABILIZE SOILS DURING COLD WEATHER MONTHS.
7. TO PREVENT WINDS AND MAINTAIN MOISTURE MAY OR STRAW SHALL BE APPLIED IMMEDIATELY AFTER SEEDING AT A RATE OF 3 TONS PER ACRE.
8. APPROPRIATE MAINTENANCE INCLUDING WATERING SHALL BEGIN IMMEDIATELY IN ORDER TO GUARANTEE A FULL AND HEALTHY STAND OF GRASS.

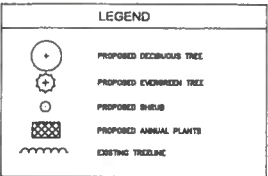

LANDSCAPE NOTES

1. THE CONTRACTOR SHALL FURNISH AND PLANT ALL PLANTS IN QUANTITIES AS SHOWN ON THIS PLAN OR LIST. UNDESIGNED AREAS, NO SUBSTITUTIONS WILL BE PERMITTED UNLESS APPROVED IN WRITING BY OWNER. ALL PLANTS SHALL BE MURDERY GROWN.
2. PLANTS SHALL BE IN ACCORDANCE WITH THE CURRENT "AMERICAN ASSOCIATION FOR HURSEY STUDY" AS PUBLISHED BY THE AMERICAN ASSOCIATION OF HURSEY.
3. PLANT STOCK SHALL BE GROWN WITHIN THE HARDINESS ZONES 4 THRU 7 ESTABLISHED BY THE PLANT HARDINESS ZONE MAP, MISCELLANEOUS PUBLICATION NO. 674, AGRICULTURAL RESEARCH SERVICE, UNITED STATES DEPARTMENT OF AGRICULTURE, LATEST EDITION.
4. ALL PLANTS MUST BE MOVED WITH THE ROOT SYSTEM AS SOLID UNITS WITH BALLS OF EARTH FINELY WEDGED WITH BURLAP. NO PLANT SHALL BE ACCEPTED WHEN THE BALL OF EARTH SURROUNDING ITS ROOTS HAS BEEN SACKS CRUSHED OR BRUSHED BEFORE PLANTING. ALL PLANTS SHALL BE THRESHLY SOIL. ALL PLANTS THAT CANNOT BE PLANTED AT ONCE MUST BE HELD-IN BY SETTING IN THE ORIGINAL, AND COVERING THE BALLS WITH SOIL, AND THEN WATERING DURING TRANSPORT. ALL PLANT MATERIALS SHALL BE WATERED WITH WIND PROOF COVERING.
5. PLANT MATERIAL SHALL BEAR THE SAME RELATIONSHIP TO FINISHED GRADE AS TO THE ORIGINAL PLANTING GRADE PRIOR TO DIGGING.
6. IT IS THE CONTRACTOR'S RESPONSIBILITY TO MAKE THE APPROPRIATE ARRANGEMENTS TO PROVIDE ALL PLANTS AND MATERIALS TO ACCOMMODATE PLANTING WITHIN THE TIME ALLOWED BY THE CONSTRUCTION SCHEDULE.
7. THE CONTRACTOR SHALL LOCATE, VERIFY AND MARK ALL EXISTING AND NEWLY INSTALLED UNDERGROUND UTILITIES PRIOR TO ANY LAWN WORK OR PLANTING. ANY CONFLICTS WHICH MIGHT OCCUR BETWEEN PLANTING AND UTILITIES SHALL IMMEDIATELY BE REPORTED TO THE OWNER SO THAT ALTERNATE PLANTING LOCATIONS CAN BE DETERMINED.
8. ALL DISTURBED AREAS NOT TO BE PAVED OR OTHERWISE TREATED, DUE TO EXCESSIVELY DRAINING SUBSURFACE, SHALL RECEIVE 6" (6) HIGH LAWN AND SEED.
9. SEE PLANTING DETAILS FOR WEED BARRIER INFORMATION AND ADDITIONAL REQUIREMENTS.
10. TREE STAKES AND WRAP SHALL REMAIN IN PLACE FOR NO LESS THAN 6 MONTHS AND NO MORE THAN 1 YEAR.
11. PLANTING SHALL BE COMPLETED FROM APRIL 15TH THROUGH OCTOBER 30TH. NO PLANTING DURING JULY AND AUGUST UNLESS SPECIAL PROVISIONS ARE MADE FOR DROUGHT.
12. TREES SHALL BE PRUNED IN ACCORDANCE WITH THE LATEST EDITION OF ANSI A300 "TREES, SHRUBS AND OTHER SEED PLANT MAINTENANCE STANDARD PRACTICES".
13. ALL PLANTS SHALL BE WATERED THOROUGHLY TWICE DURING THE FIRST 24 HOUR PERIOD AFTER PLANTING. ALL PLANTS SHALL BE WATERED WEEKLY, OR MORE OFTEN, IF NECESSARY DURING THE FIRST GROWING SEASON, NOT LESS THAN ONE YEAR.
14. EXISTING TREES SHOWN ON THE PLAN ARE TO REMAIN UNDISTURBED. ALL EXISTING TREES SHOWN TO REMAIN ARE TO BE PROTECTED WITH A 4-FOOT SNOW FENCE PLACED AT THE DROP LINE OF THE BRANCHES.
15. THE CONTRACTOR SHALL MAINTAIN AND GUARANTEE ALL PLANTINGS TO BE IN GOOD HEALTH, FLOURISHING AND ACCEPTABLE CONDITION FOR A PERIOD OF (3) YEAR BEGINNING AT THE DATE OF ACCEPTANCE OF SUBSTANTIAL COMPLETION. ALL GRASSES, TREES AND SHRUBS THAT IN THE OPINION OF THE LANDSCAPE ARCHITECT, SHOW LESS THAN GOOD HEALTHY GROWTH AT THE END OF (3) YEAR PERIOD SHALL BE REPLACED BY THE CONTRACTOR.
16. ALL MULCH WITHIN BEDS IS TO BE LAID OVER APPROVED LANDSCAPE WEED FABRIC TO PREVENT WEED GROWTH.
17. PLANT GROUPINGS SHALL BE SUBORDINATE INTO PLANTING BEDS UNLESS OTHERWISE NOTED. WHERE MULCHED PLANT BEDS ADJUT LAWN, FENCE OR TURF CUT EDGE, WHERE MULCHED PLANT BEDS ADJUT PAVEMENT, EDGES SHALL INTERSECT AT 90 DEGREE.
18. PROPOSED TREES OVERHANGING SIDEWALKS, ROADS, OR PARKING SHALL BEEN BRANCHING NATURALLY (NOT PRUNED) AT 4' HEIGHT.
19. ALL PLANTS SHALL BE WATERED THOROUGHLY DURING THE FIRST 24 HOUR PERIOD AFTER PLANTING. ALL PLANTS SHALL BE WATERED WEEKLY, OR MORE OFTEN, IF NECESSARY DURING THE FIRST GROWING SEASON.
20. LANDSCAPE PLAN IS FOR APPROVAL ONLY. DO NOT USE LANDSCAPE PLAN FOR CONSTRUCTION.

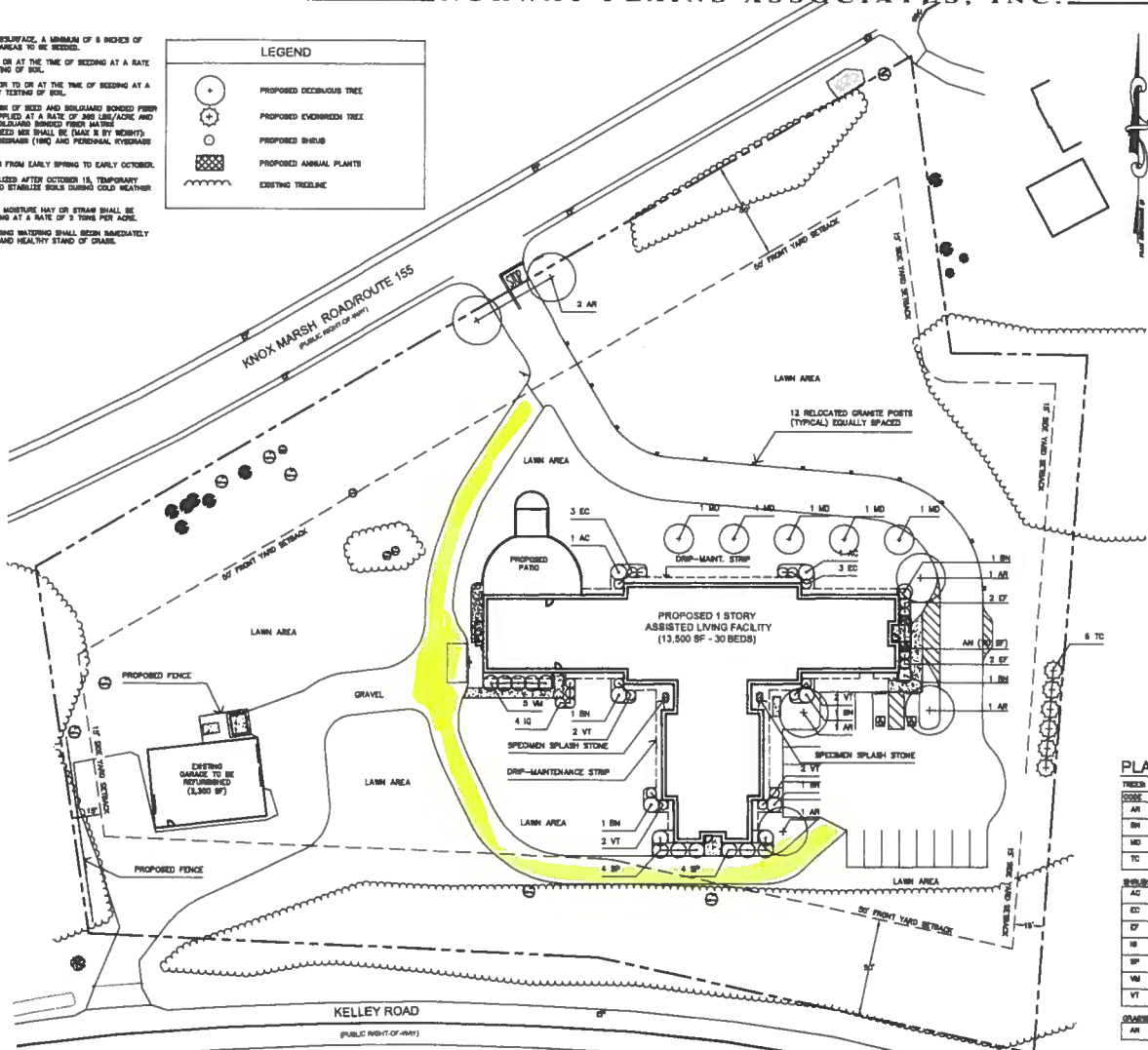

PLANT LIST

| CODE | BOTANICAL NAME | COMMON NAME | QUANTITY | SIZE | ROOTS | COMMENTS |
|----------------------------------------------|----------------------------------------|--------------------------------|----------|------------|-----------|------------------------------------------------|
| AR | ACER RUBRUM "OCTOBER GLORY" | OCTOBER GLORY RED MAPLE | 8 | 2 1/2" DBH | BAR | SINGLE STRAIGHT MAIN TRUNK, FULL & BUSHY CROWN |
| BR | BETULA NIGRA "LITTLE KING" | FOX WALLEY RIVER BIRCH | 8 | 6" HT. | BAR | 3 LEADER TRUNK CLUMP, FULL & BUSHY CROWN |
| MD | MALUS "DONALD WYMAN" | DONALD WYMAN CRABAPPLE | 8 | 3" CAL. | BAR | SINGLE STRAIGHT MAIN TRUNK, FULL & BUSHY CROWN |
| TC | TILIA CANADENSIS | CANADIAN HEMLOCK | 8 | 6" HT. | BAR | SINGLE STRAIGHT MAIN TRUNK, FULL & BUSHY CROWN |
| SHRUBS | | | | | | |
| AC | AMELANCHIER S.G. "ROBIN HILL" | ROBIN HILL BERRYDOGWOOD | 2 | 6" HT. | BAR | FULL & BUSHY CROWN |
| EC | ERIGONANTHEUS CAMPANULATUS | REVEREN ERIGONANTHEUS | 8 | 20" HT. | BAR | FULL & BUSHY |
| EF | ERIGONANTHEUS FORTUNAE "SHERALD SMITH" | SHERALD SMITH ERIGONANTHEUS | 4 | 9 CAL. | BAR | FULL & BUSHY |
| IB | ILEX GLABRA "COMPACTA" | SHINY BERRYBERRY | 4 | 30" HT. | BAR | FULL & BUSHY |
| SP | SPYRINIA PARULA "BESS HEN" | BESS HEN LILAC | 8 | 3" HT. | CONTAINER | FULL & BUSHY |
| VM | VERONICA P.T. "MARICHI" | MARICHI DOORDOORVILLE VERONICA | 8 | 3" HT. | BAR | FULL & BUSHY |
| VT | VERONICA TRICOLOR "COMPACTA" | COMPACT AMERICAN DOORDOORVILLE | 8 | 30" HT. | BAR | FULL & BUSHY |
| GRASSES, ORNAMENTAL GRASSES AND BULBS | | | | | | |
| AN | ANNUALLY COLORED ANNUALS | | 70 | S.F. | CONTAINER | PLANT 12" O.C., INSTALL FOR DRAINAGE OPENINGS |

| | | | |
|-----------|--------|-----------------------|---------|
| FILE NO: | 303 | | |
| JOB NO: | 14010 | | |
| F.B. NO: | MSC | | |
| PLAN NO: | C-2691 | | |
| SCRD NO: | | | |
| DRAWN BY: | RRL | | |
| CHECK BY: | RRL | | |
| DWG NO: | LAND | | |
| NO. | 1 | ADDED TREATMENT SWALE | 2/14/10 |
| REVISION | DATE | | |

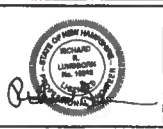

LANDSCAPE ARCHITECT:
NPA
 NORWAY PLAINS ASSOCIATES, INC.
 SLAVYORA
 SEPTIC SYSTEM DESIGNERS
 ALTON
 170 Commerce Way,
 Suite 102
 Portsmouth, NH 03801
 P 603-431-4000
 31 Mossey Street
 Alton, NH 03809
 (603) 675-3948
 www.norwayplains.com

NPA
 ASSOCIATES, INC.
 ENGINEERS
 TRANSPORTATION PLANNERS
 ROCKEFELLER
 2 Commercial Boulevard
 P.O. Box 249
 Rochester, NH 03866-0249
 (603) 356-9948

AMMENDED SITE DEVELOPMENT PLAN
 PROPERTY OF
JASON W. BERNDTSON
 123 DOVER ROAD
 DURHAM, NH 03824
 SCRD: BK 3141, PG 84 & BK 3068, PG 199

LANDSCAPE PLAN
 CARRIAGE HILL ASSISTED LIVING
 TAX MAP 9 LOTS 8 & 8A
 304 & 306 KNOX MARSH ROAD/RTE. 155
 MADBURY, NEW HAMPSHIRE
 STRAFFORD COUNTY

1" = 30' FEET
 REV: 02-14-14
C-004